



The Owls House

Pill Creek





The Property

- Stunning Creekside position
- Beautifully refurbished and extended accommodation, combining elegance with modern convenience
- Private, peaceful and sunny position
- Direct water access from landscaped, terraced gardens
- Air source heating and solar panels
- One bedroomed detached waterside boathouse
- Welcoming reception hall with elegant timber panelling and ceramic tiled floor
- Double aspect kitchen/dining room, perfectly positioned to enjoy the views
 - Charming bay window framing the idyllic surroundings
 - Large island unit with double sink and integral dishwasher
 - Angemaster cooker with hood, fitted fridge, separate freezer
 - Pantry cupboard

- Comfortable sitting room with wood burner, bay window, and French doors to the terrace
- Convenient utility room & plant room cupboard
- Ground floor WC
- Galleried landing, enhancing space and natural light
- Luxurious master bedroom with en suite shower room and walk-in wardrobe
- Two further double bedrooms, both with picturesque views, one featuring an elegant bay window and extensive fitted wardrobes
- Well-appointed family bathroom with separate shower

Boat House

- Detached former boathouse on the water's edge enjoying the beautiful outlook
- Beautifully refurbished providing one bedroomed / studio ancillary accommodation





The Owls House, Pill Lane, Feock, Truro, TR3 6SE

This impeccably refurbished and extended creekside cottage enjoys direct water access at the head of Pill Creek. Boasting a southwest-facing aspect, beautifully landscaped terraced gardens and a charming waterside one-bedroom boathouse, The Owls House is true masterpiece of quality and elegance within in a prime coastal setting.

Location

Nestled within this wooded setting at the head of Pill Creek, The Owls House is perfectly situated for the outdoor-based lifestyle this idyllic location provides.

Many walks abound in the area, including around Trelissick, where there is a beautiful woodland walk along the banks of the River Fal, to Loe Beach where there are sailing facilities and popular café, and to Restrounguet Point, Harcourt, Trolver Croft and Goonpiper.

In addition to the sailing, dinghy launching and kayaking facilities at Loe Beach, there are numerous sailing clubs around the shoreline of the Carrick Roads, notably at Mylor Harbour, which over recent years has become the county's pre-eminent boating centre. Golf courses are nearby at Truro and Falmouth. There are highly regarded primary schools within a short drive at Devoran and Kea.

The thriving university town of Falmouth is approximately ten miles distant, offering a fine range of restaurants, quayside bars, galleries, sub-tropical gardens and safe sandy bathing beaches. The South West Coast Path then continues to the neighbouring coves at Swanpool, Maenporth and beyond onto the beautiful Helford River.

The Roseland Peninsula is only a short drive away via the iconic King Harry Ferry where St Mawes, Portscatho, Vryan, Carne and Pendower all provide superb dining, art, beach, sailing and walking opportunities.



The Gardens and Parking

- Brick paved driveway providing parking for 4 cars
- EV charging point
- Expansive full width terrace enjoying the sunny aspect and peaceful setting, featuring glass balustrades and covered area
- Lower sitting out terrace
- Beautifully landscaped gardens, terraced with paths connecting and leading to the water's edge
- Timber decked terrace with kayak storage undercroft (adjacent to the boathouse)

Distances

Loe Beach (Feock) - 0.7; Trelissick Gardens (National Trust) - 1; Devoran - 3; Truro - 5; Portscatho (via King Harry Ferry) - 6.5; St Mawes (via KHF) - 7; Carne Beach (via KHF) - 8.5; Mylor Yacht Harbour - 9.5; Falmouth - 10.5; Helford Passage - 13.5; Cornwall Airport (Newquay) - 27
(All distances are approximate and in miles)

Services, tenure and material information

Freehold. Mains electricity and water. Air source heating, underfloor heating throughout the ground floor. Solar panels.

Council Tax: Owls House - E; Boat House - A

Broadband: Fibre (to cabinet) is available (source: www.openreach.com/broadband-network/fibre-availability)

What 3 Words /// rules.freely.pill

Directions

From Truro, take the A390 to Falmouth, turning left at the second roundabout at Playing Place, immediately after the Shell garage, signposted to Feock and the King Harry Ferry. Continue along this road, past The Punchbowl and Ladle and after approximately half a mile turn left at the crossroads signposted Trelissick and the King Harry Ferry. Take the first turning on the right and turn right at the T-junction. Proceed towards the bottom of the hill and take the left-hand turning into Pill Lane where The Owls House is the third property on the right.



The Owls House, Pill Lane, Feock, Truro, TR3 6SE

Main House = 1777 sq ft / 165 sq m
Total = 2038 sq ft / 189.3 sq m (includes Boat House)

For identification only - Not to scale

Score	Energy rating	Current	Potential
92+	A		
81-91	B		
69-80	C	75 C	76 C
55-68	D		
39-54	E		
21-38	F		
1-20	G		

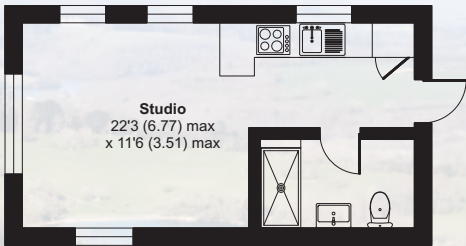

BOAT HOUSE

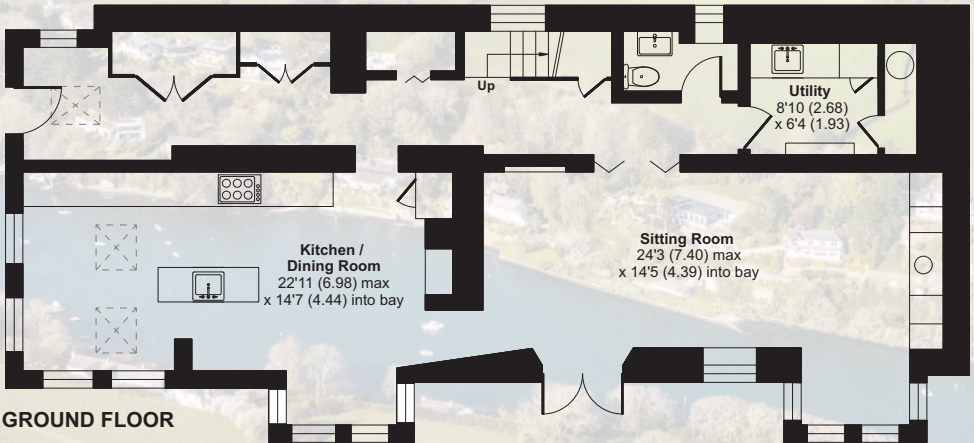

GROUND FLOOR

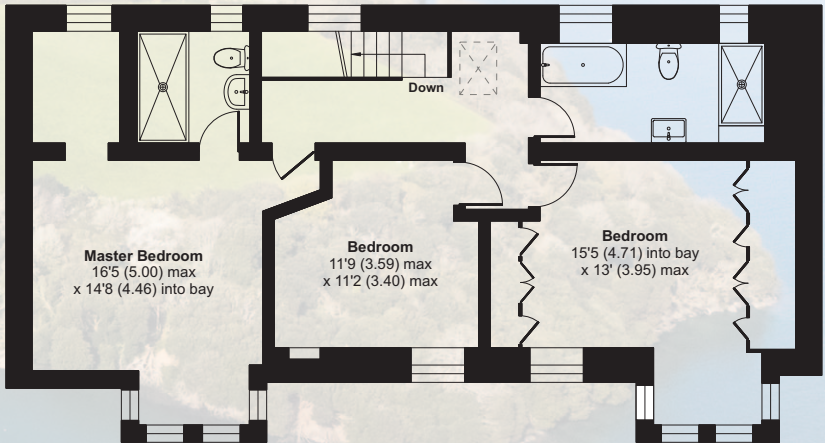

FIRST FLOOR



Floor plan produced in accordance with RICS Property Measurement 2nd Edition, Incorporating International Property Measurement Standards (IPMS2 Residential). © nitchecom 2025. Produced for Shore Partnership Limited. REF: 1276100

FIXTURES & FITTINGS

Only those fixtures and fittings mentioned specifically in the sales particulars are to be included in the sale. All others (including light fittings not mentioned, furniture, garden furniture, garden ornaments etc) are not included but may be available by separate negotiation.

IMPORTANT NOTICE Shore Partnership, their clients and any joint agents give notice that: 1. They are not authorised to make or give any representations or warranties in relation to the property either here or elsewhere, either on their own behalf or on behalf of their client or otherwise. They assume no responsibility for any statement that may be made in these particulars. These particulars do not form part of any offer or contract and must not be relied upon as statements or representations of fact. 2. Any areas, measurements or distances are approximate. The text, images and plans are for guidance only and are not necessarily comprehensive. It should not be assumed that the property has all necessary planning, building regulation or other consents and Shore Partnership has not tested any services, equipment or facilities. Purchasers must satisfy themselves by inspection or otherwise.





Ben Davies
Director



Tim May
Director

WHERE YOU LIVE MATTERS

Telephone: 01872 484484
Email: contact@shorepartnership.com

School House Office, Market Street,
Devoran, Truro, Cornwall, TR3 6QA

